

Direct Acting, M5, 3/2 Function Compact Solenoid Valve

RGS

Description

3 port 2 position direct acting, spring return, normally closed, compact solenoid valve, for the operation of single acting pneumatic devices.

Features

- Continuously Rated.
- Compact design.



Valve is illustrated with a Mini Plug & Socket Coil

Product Code :

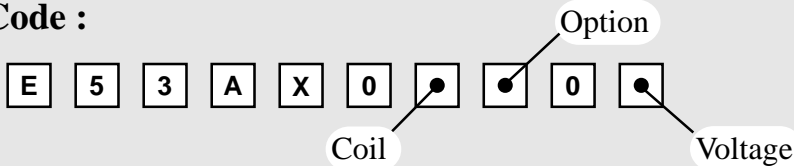

See below for product code details
Any of the below options that are not required enter '0' in relevant box.

Coil

Coil:	Code:
MC30 Plug & Socket	K
No coil (with stem)	2

Option

Options:	Code:
Screw Driver Override	S
No Option Required	0

Voltage

Voltage:	Code:	Voltage:	Code:
12v DC	A	12v AC (50/60 Hz)	P
24v DC	B	24v AC (50/60 Hz)	R
48v DC	C	48v AC (50/60 Hz)	S
110v DC	D	110v AC (50/60 Hz)	T
No voltage (no coil)	0	240v AC (50/60 Hz)	U

Direct Acting, M5, 3/2 Function Compact Solenoid Valve

RGS

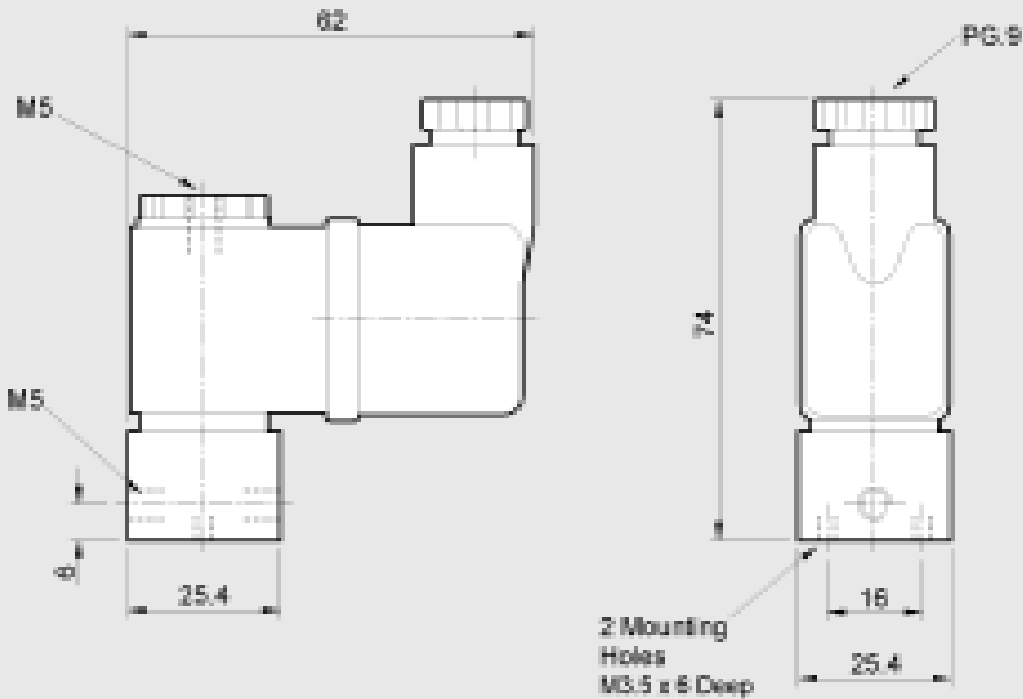

Material Specification	Standard
Body	Black Anodised Aluminium (Dural)
Seals	Nitrile & Viton

Valve Specification	Standard
Port Connection Size	M5
Working Pressure	0 to 8 bar
Cv Factor	0.06
Flow Rate (at 6 bar with 1 bar pressure drop)	62 l/min
Maximum Ambient Temperature	+60 C
Minimum Working Temperature	-10 C
Inlet Orifice	1.0 mm
Exhaust Orifice	1.2mm

Coil Type	Mini Plug & Socket
Area Class	Safe
Area Category	N/A
Ingress Protection	IP65
Cable Entry	PG.9
Ambient Temp.	-10 to 60°C
Coil Class	F

Non-Standard Features and Options

There are non-standard alternatives available in addition to those listed within this datasheet for:

- Material Specification
- Valve Specification
- Options
- Voltages

Please refer to Section 9 in this catalogue for details of these alternatives.